



**IP PoE LED
Displays**

About our IP PoE LED Displays

Netgenium's IP PoE LED display bring modern messaging and visual alerts to your buildings using a simple PoE connection. With pixel pitches as fine as P1.25mm, these modular displays can be used for everything from visitor information and safety alerts to production line stats and large venue displays.

Each display connects to your network and draws power via PoE, drastically reducing cabling requirements. Whether wall-mounted in reception or scaled into a video wall, these displays can be managed via NGxControl — allowing live updates, scheduled messages, or automation based on access or alarm events.

Designed for both indoor and outdoor use (IP-rated models available), these LED displays are perfect for multiple applications from Automatic Number Plate Recognition (ANPR), "Welcome" messages to "Lockdown in progress," Netgenium LED displays are clear, dynamic, and built to inform.

If you have a size in mind not present within the brochure please contact us to discuss your requirements.

Key Benefits

- **PoE-powered** – one cable for power, signal & control
- **Modular design** – scale from small to large formats
- **High-resolution (P1.25)** – crisp, clear messaging
- **Remote updates** – manage content centrally
- **Emergency-ready** – display automated alerts
- **Indoor/outdoor options** – flexible deployment
- **Low maintenance** – reliable and efficient

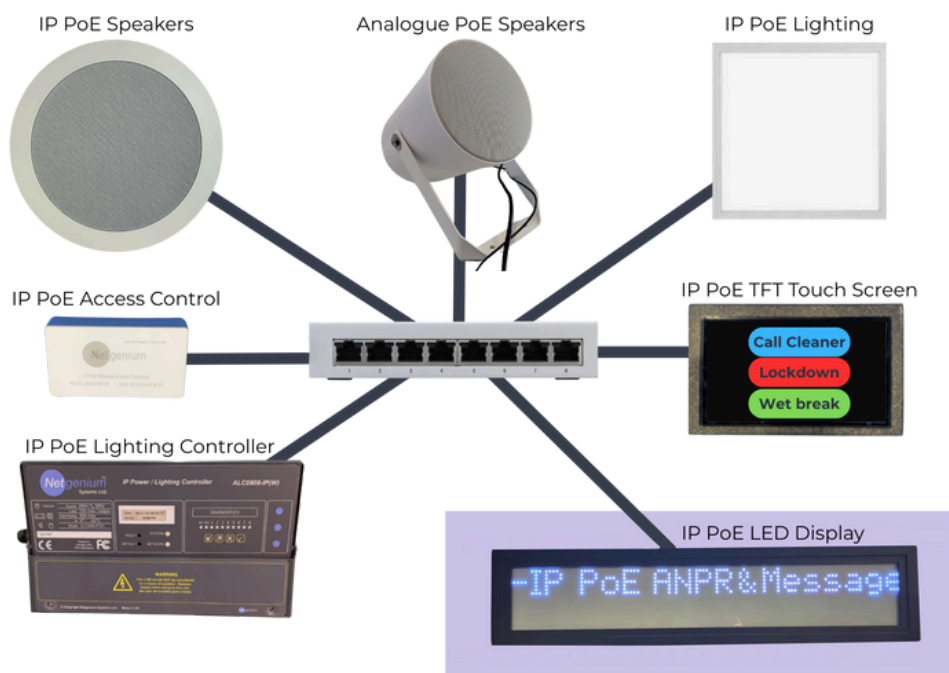

AMD0301-IP

The AMD0301-IP is a compact, IP-rated PoE LED display designed primarily as a brick light, perfect for architectural and signage applications. With Power-over-Ethernet support, it offers streamlined installation and reliable performance in both indoor and outdoor environments.

Featuring 192 fully addressable RGB LEDs, it can display dynamic patterns, scrolling text, and simple graphics—ideal for wayfinding, branding, or ambient effects. Its vivid output and fine pixel control make it a versatile tool for creative lighting design.

Durable, smart, and highly adaptable, the AMD0301-IP transforms static walls into vibrant, interactive canvases—bringing modern flexibility to architectural lighting.

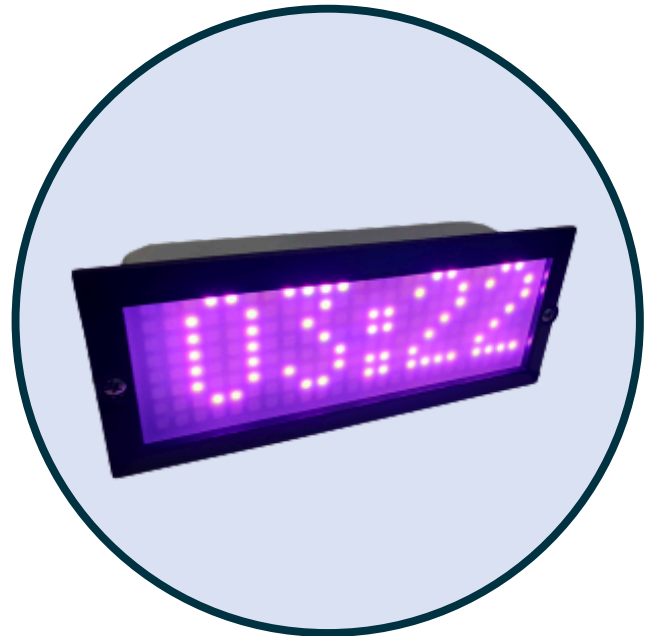

192 Fully Addressable RGB LEDs

Create vibrant patterns, animations, text, and graphics with precise pixel control.

1 Cable Installation

Power from PoE and connect to your network with a single cable.

Flexible Content Support

Ideal for patterns, text, graphics, and responsive display applications.

Energy-Efficient Operation

Low power consumption with high-impact visual output.



IP PoE LED Displays

AMD0301-IP Technical Data

Model No:

AMD0301-IP

Connectivity:

1 No. RJ45 Socket

Display:

Resolution Px
Colour

P8 24x8
Full RGB

Storage:

Onboard Flash Memory (For user functionality)

~8MB

Power Supply:

PoweroverEthernet

IEEE802.3at or IEEE802.3af

Mechanical:

Dimensions,width,height&depth,mm
Material

230x100x80 (Brick Light Format)
Painted Aluminium Rear (White)
Painted Front Aluminium Bezzel (Black)
With frosted glass

AMD0601-IP

The AMD0601-IP is a powerful, IP-rated PoE LED display designed to elevate architectural lighting and signage. With a sleek, brick light form factor and support for Power-over-Ethernet, it installs cleanly in walls, facades, or custom enclosures—indoors or out—while delivering reliable performance and streamlined wiring.

Packed with 384 fully addressable RGB LEDs, the AMD0601-IP doubles the visual potential of its smaller sibling. From flowing animations and vibrant patterns to scrolling text and pixel-based graphics, it offers expanded resolution and richer effects, perfect for interactive displays, wayfinding, or bold branding statements in public and commercial spaces.

Built for adaptability, the AMD0601-IP supports a wide range of control protocols, making it easy to integrate into complex lighting systems. Whether enhancing a modern building facade or powering attention-grabbing installations, it turns ordinary surfaces into dynamic, eye-catching experiences.



384 Fully Addressable RGB LEDs

Create vibrant patterns, animations, text, and graphics with precise pixel control.

Flexible Content Support

Ideal for patterns, text, graphics, and responsive display applications.

1 Cable Installation

Power from PoE and connect to your network with a single cable.

Energy-Efficient Operation

Low power consumption with high-impact visual output.

AMD0601-IP Technical Data

Model No:

AMD0601-IP

Connectivity:

1 No. RJ45 Socket

Display:

Resolution Px

P8 48x8

Colour

Full RGB

Storage:

Onboard Flash Memory (For user functionality)

~8MB

Power Supply:

PoweroverEthernet

IEEE802.3at or IEEE802.3af

Mechanical:

Dimensions,width,height&depth,mm

680x165x70

Material

RAL7016 Aluminium Housing with polycarbonate screen

AMD0901-IP

The AMD0901-IP is the ultimate PoE-powered LED brick light, designed for large-scale architectural and signage applications where visual impact is everything. With an IP-rated enclosure and streamlined Power-over-Ethernet setup, it offers robust performance and hassle-free installation—indoors or outdoors.

With 576 fully addressable RGB LEDs, the AMD0901-IP delivers high-density, high-resolution lighting. It excels at displaying complex animations, smooth gradients, scrolling text, and low-res graphics, making it ideal for bold branding, immersive installations, or smart wayfinding in high-traffic environments.

Despite its compact form, the AMD0901-IP offers unmatched versatility and dynamic control. Seamlessly integrate it into larger lighting systems, schedule content, or respond in real time—transforming any surface into a vibrant, programmable canvas for creative expression.

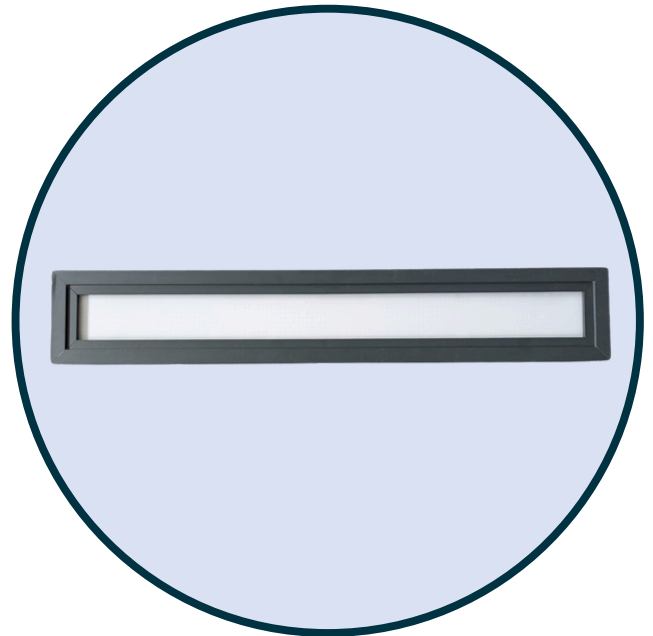

576 Fully Addressable RGB LEDs

Create vibrant patterns, animations, text, and graphics with precise pixel control.

1 Cable Installation

Power from PoE and connect to your network with a single cable.

Flexible Content Support

Ideal for patterns, text, graphics, and responsive display applications.

Energy-Efficient Operation

Low power consumption with high-impact visual output.

AMD0901-IP Technical Data

Model No:

AMD0901-IP

Connectivity:

1 No. RJ45 Socket

Display:

Resolution Px

P8 72x8

Colour

Full RGB

Storage:

Onboard Flash Memory (For user functionality)

~8MB

Power Supply:

PoweroverEthernet

IEEE802.3at

Mechanical:

Dimensions,width,height&depth,mm

975x165x70

Material

RAL7016 Aluminium Housing with
polycarbonate screen

AMD0902-IP

The AMD0902-IP offers the highest LED count in the AMD display series, delivering exceptional visual clarity and smooth content playback. With an IP-rated enclosure and Power-over-Ethernet support, it's designed for reliable, low-maintenance operation in both indoor and outdoor environments.

Featuring 1152 fully addressable RGB LEDs, the AMD0902-IP is capable of displaying detailed animations, vibrant patterns, scrolling text, and low-res graphics with ease. Its high pixel density makes it well-suited for applications that demand crisp visuals and fluid transitions.

Compatible with a variety of control systems, the AMD0902-IP enables dynamic content management and real-time responsiveness. Whether used for signage, ambient effects, or creative displays, it provides a flexible and visually striking solution in a streamlined format.



1152 Fully Addressable RGB LEDs

Create vibrant patterns, animations, text, and graphics with precise pixel control.

1 Cable Installation

Power from PoE and connect to your network with a single cable.

Flexible Content Support

Ideal for patterns, text, graphics, and responsive display applications.

Energy-Efficient Operation

Low power consumption with high-impact visual output.

AMD0902-IP Technical Data

Model No:

AMD0902-IP

Connectivity:

1 No. RJ45 Socket

Display:

Resolution Px

P8 72x16

Colour

Full RGB

Storage:

Onboard Flash Memory (For user functionality)

~8MB

Power Supply:

PoweroverEthernet

IEEE802.3at

Mechanical:

Dimensions,width,height&depth,mm

975x230x70

Material

RAL7016 Aluminium Housing with
polycarbonate screen